



SINACO ENGINEERS (PVT) LIMITED

95364

Site Demand

30-September-2023

Project : GCL Wall Tile

Demand no : SD-92-2023-00100

Created By : umarmujahid876

Date : 30-September-2023

Description : Crush, Chanab Sand, Gravel, Local Sand

S/N	Item	Description	Unit	D-Quantity	R-Quantity	Unit Price	Total	Required Till	ReviewedBy	ApprovedBy	Demand FulFilled
1	Crush	3/8", Concrete for Road	cft	3245.00	3245.00			03/10/2023			Head office Purchase
2	Crush	1/2", Concrete for Road	cft	4868.00	4868.00			03/10/2023			Head office Purchase
3	Sand - Sand	Chanab Sand, Concrete For Road	cft	3500.00	3500.00			03/10/2023			Head office Purchase
4	Crush	For BPD Area	cft	81551.00	81551.00	74750		03/10/2023			Head office Purchase
5	Sand - Sand	Local sand, for BPD Area	cft	81551.00	81551.00	74750		03/10/2023			Head office Purchase
6	Crush	3/8", For BPD Area Raft & PCC	cft	26552.00	26552.00			03/10/2023			Head office Purchase
7	Crush	1/2", For BPD Area Raft & PCC	cft	39784.00	39784.00			03/10/2023			Head office Purchase
8	Sand - Sand	Chanab Sand, For BPD Area Raft & PCC	cft	24477.00	24477.00			03/10/2023			Head office Purchase
9	Sand - Sand	L Pur Sand, For BPD Area Raft & PCC	cft	12500.00	12500.00			03/10/2023			Head office Purchase

Total

02-10-23

30/9/23

3/11/23

4 Moulis deferred payment

SINACO ENGINEERS (PVT) LTD

PURCHASE REQUEST



PROJECT:
NATIONAL FOODS PSD
GCLFSD

Dated: 30/9/23
SITE CONTACT PERSON: NAVEED AHMAD
MOBILE: 0300-9301674

S/N	DESCRIPTION	QUANTITY	UNIT	RATE	AMOUNT	REMARKS
	Crush. 3/8" down	3245	CFI			
	" 1/2" down	4868	CFI			
	Chinab sand.	3500	CFI			
	L/P sand.					
			Crush.	Chinab		L/P Sand
	Concrete for Roadwork Line J 3000 psi Qty = 106 m ³	3185	CFI	1012.30		1012.30
	Rec 1.48 Underfloor Insul/Anch Qty 1.64 m ³	4928.20	"	3132.40		
		8113.20		4144.70		1012.30
				GRAND TOTAL		

Khan
30/9/23

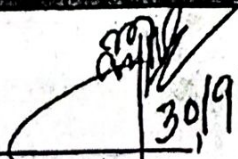
 Requesting Person: _____
 Purchase Department: _____
 Authorizing Person: _____

SINACO ENGINEERS (PVT) LTD



PURCHASE REQUEST

PROJECT:
REGIONAL ROADS
G.R.L PSD.

Dated: 30/9/2023
SITE CONTACT PERSON NAVEED AHMAD
MOBILE: 0300-0301674

S/N	DESCRIPTION	QUANTITY	UNIT	RATE	AMOUNT	REMARKS
	Crush 3/8"	26552	CFT			
	Crush 1/2"	39784	CFT			
	Sand (Chinab)	24477	CFT			
	Sand. L/Pur.	12500	CFT			
	BPD Area Raft & P.C.C. Concrete & Material.	66306	CFT	24477	17667	Chinab Sand. HP Sand.
	Material arrive/stock	-	-	-	5000	CFT
					12667	CFT
GRAND TOTAL						

[Signature]
30/9/23

Requesting Person

Purchase Department

Authorizing Person



Project:- CONSTRUCTION OF WALL TILE LINE 15,000 M2 AT FIEDMC, FAISALABAD

Client :- Ghani Ceramics

Contractor:- Sinaco Engineers (PVT) Limited, 12-G Model Town Lahore

S.No	BPD Tank Area	Quantity (M ³)	Quantity (Cft)	Sand (Cft) <i>chimb.</i>	Crush (Cft)	Gravel (Cft) <i>LP Sand</i>
1	Sand:Gravel Filling	3,420.651 ✓	120,817.40			
2	P:CC (1:4:8)	356.512 ✓		6810	16713	
3	R:C:C (Raft) 300 Psi	1,849.318 /		17667	55593	17667
				24477	66306	17667

working by Usman Meer:

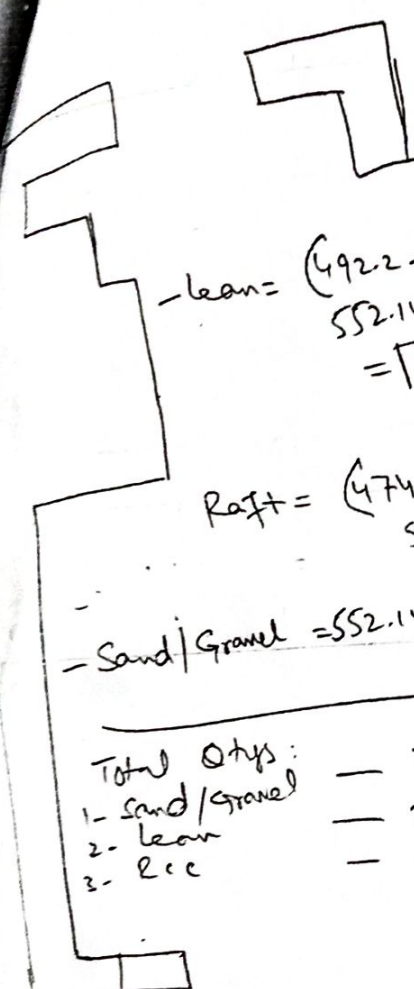

$$\text{lean} = (492.2 + 59.94) \text{ M}^2 \times 0.075 = 41.4 \text{ M}^3$$

$$\text{Raft} = (474.5 + 55) \times 0.45 = 238.3 \text{ M}^3$$

$$\text{Sand/Gravel} = 552.14 \times 0.5 = 276.07 \text{ M}^3$$

- Total Qty's:
- 1- Sand/Gravel — 3387 M³
 - 2- lean — 352.4 M³
 - 3- Rcc — 178.3 M³

$$\text{lean} = 3110.6 \text{ M}^2 \times 0.1 \text{ M} = 311 \text{ M}^3$$

$$\text{Raft} = 3085.86 \times 0.5 = 1543 \text{ M}^3$$

$$\text{Sand/Gravel} = 3110.6 \text{ M}^2 \times 1 \text{ M} = 3110.6 \text{ M}^3$$

Descriptor	Qty (cft)	Gravel (cft)	chems sand (cft)	Upur sand (cft)	Crush (cft)
Sand/Gravel @ 25'	149500	74750	74750	—	12500
lean	12500	—	3125	3125	88000
Rcc Raft	63000	—	45750	15750	—
Total	—	69200	88125	18875	175500

23786

12797