



# SINACO ENGINEERS (PVT) LIMITED

Site Demand

Project : GCL Wall Tile

Demand no : SD-92-2023-00114

04-November-2023

Created By : umarmujahid876

Date : 25-October-2023

Reviewed By :

Description : PVC Water Stopper  
200MM Wide 4MM Thick

Reviewed Date :

Approved By :

Approved Date :

| S/N          | Item                              | Description  | Unit | D-<br>Quantity                       | R-<br>Quantity | Unit<br>Price | Total | Required<br>Till | Demand<br>FulFilled |
|--------------|-----------------------------------|--|------|--------------------------------------|----------------|---------------|-------|------------------|---------------------|
| 1            | Consumables<br>- Water<br>Stopper | [1075<br>Rm],PVC<br>Water<br>Stopper<br>200MM<br>Wide 4MM<br>Thick | RFT  | <del>3527.00</del><br>3600<br>2100 ✓ |                |               |       | 06/11/2023       |                     |
| <b>Total</b> |                                   |  |      |                                      |                |               |       | 0                |                     |

*David*  
7/11/23

*[Signature]*  
4/11/23

*[Signature]*  
06-11-23

# SINACO ENGINEERS (PVT) LTD



## PURCHASE REQUEST

Dated: 24/1/23

SITE CONTACT PERSON NAVEED AHMAD

MOBILE: 0300-0301874

PROJECT:  
NATIONAL FOODS-FSD

| S.N         | DESCRIPTION                              | QUANTITY               | UNIT      | RATE | AMOUNT           | REMARKS |
|-------------|--|------------------------|-----------|------|------------------|---------|
| ①           | Pvc water stoper 200mm wide<br>4mm Thick | <del>375</del><br>1075 | RM.<br>Rm |      | 200<br>3600 RPL. |         |
|             |  | 1094                   | Rm        |      |                  |         |
|             |  | = 3                    | 510x      |      |                  |         |
| GRAND TOTAL |  |                        |           |      |                  |         |

*24/1/23*  
*24/1/23*

\_\_\_\_\_  
Requesting Person

\_\_\_\_\_  
Purchase Department

\_\_\_\_\_  
Authorizing Person



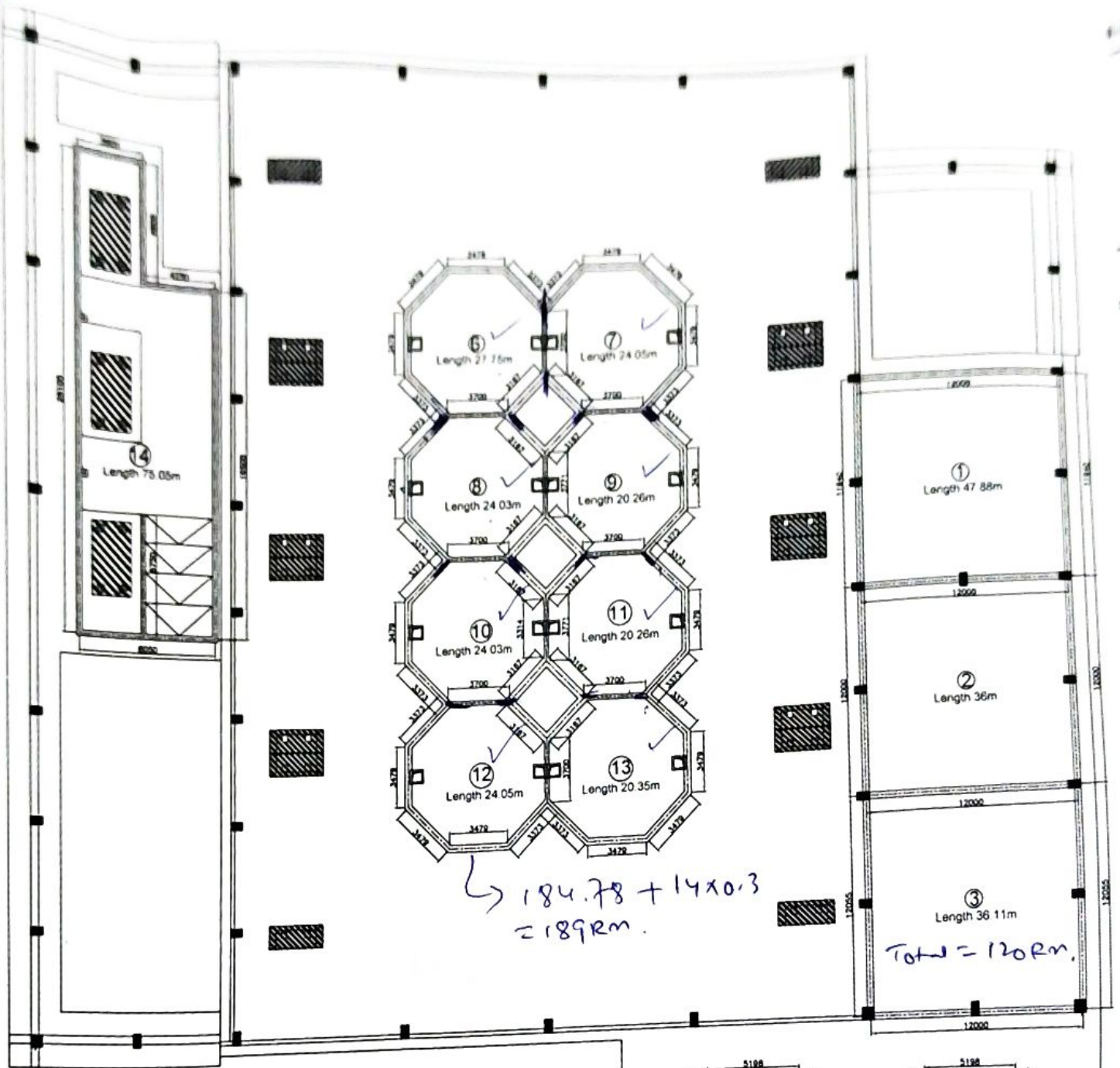

$\hookrightarrow 184.78 + 14 \times 0.3$   
 $= 189m.$

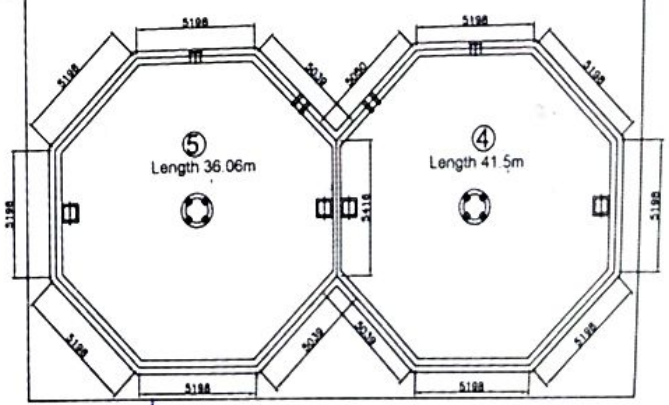

$\hookrightarrow \text{Total} = 77.56m$   
 $+ 0.6$   
 $\hline$   
 $78.16m$